

D151 PN20



WRAS
APPROVED
PRODUCT
(1/4" to 2" only)

Bronze Gate Valve

Crane gate valves offer the ultimate in dependable service wherever minimum pressure drop is important. The D151 carries the British Standards Institution kitemark - your assurance of exacting quality standards. In addition, the D151 is WRAS approved for use on wholesome (potable) water.

Materials

PART	MATERIAL	SIZES
Body	Bronze BS EN 1982 CC491K	All
Bonnet	Bronze BS EN 1982 CC491K	All
Stem	DZR Brass BS EN 12164 CW602N	1/4 - 3
Stem	Manganese Bronze	4
Disc	Bronze BS EN 1982 CC491K	All
Stem Retainer	DZR Brass BS EN 12164 CW602N	1/2 - 2
Stuffing Box	DZR Brass BS EN 12164 CW602N	1/4, 3/8, 2 1/2 & 3
Stuffing Box	Bronze BS EN 1982 CC491K	4
Packing	Asbestos Free	All
Packing Gland	Brass BS EN 12164 CW614N	1/4, 3/8, 1 - 3
Packing Gland Nut	Brass BS EN 12164 CW614N	1/2 & 3/4
Packing Gland	Bronze BS EN 1982 CC491K	4
Packing Nut	Brass BS EN 12164 CW614N	1/4 - 3
Packing Nut	Bronze BS EN 1982 CC491K	4
Handwheel	Aluminium	1/4 - 3
Handwheel	Malleable Iron BS EN 1562 GJMB-300-6	4
ID Plate	Aluminium	All
Handwheel Nut	Brass BS EN 12164 CW614N	All
Gasket	Asbestos Free	3 - 4



Dimensional Drawing

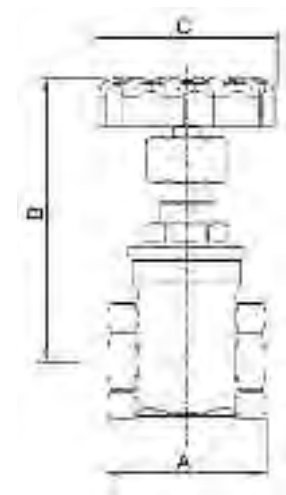

Dimensions & Weights

SIZE (inch)	WEIGHT (kg)	A (mm)	B (mm)	C (mm)
1/4	0.27	46	75	45
3/8	0.26	46	75	45
1/2	0.269	50	78	52.5
3/4	0.384	54	84	52.5
1	0.593	62	105	65
1 1/4	0.844	71	111	70
1 1/2	1.266	77.5	130	78
2	1.881	87.5	153	92
2 1/2	4.37	96	219	121
3	6.4	105	259	121
4	19.7	162	366	203

Pressure/Temperature Ratings

TEMPERATURE (°C)	-10 to 100	180
PRESSURE (BAR)	20	9

Intermediate pressure ratings shall be determined by interpolation.

PRESSURE RATING: PN20

TEMPERATURE OPERATING RANGE: -10 to 180°C

UK END CONNECTION: Taper threaded to BS EN 10226-2 (ISO 7-1) formerly BS 21

US END CONNECTION: ANSI B1.20.1 (please add suffix AT to denote American Thread)

OPERATOR: Handwheel.

Gate valves are best for services that require infrequent valve operation, and where the disc is kept either fully opened or fully closed. They are not practical for throttling.

SPECIFICATION: Solid wedge disc, non-rising stem, screwed in bonnet. Valves are manufactured in accordance with BS EN 12288: 2010 PN20 Series B and are BSI Kitemark approved.

This valve is not suitable for use on group 1 gases or unstable fluids, as defined by the Pressure Equipment Directive 97/23/EC.